

MATERIAL SPECIFICATION SHEET

Brass Gas Ball Valve - Flare x Male NPT



Engineered for reliability and durability, these brass gas valves meet stringent industry standards and are suitable for residential, commercial, and industrial gas applications.

- Forged Brass Body
- Thread Conform to ANSI B1.20.1
- Blow Out Proof Brass Stem Design
- Packing Nut & O-RING
- Max Working Pressure 250psi
- Temperature Range: -4°F (-20°C) to 149°F (65°C)



Material List

No.	Item	Material
1	Body	Brass
2	Seat	PTEE
3	Ball	Brass/Chrome Plated
4	O-Ring	NBR
5	Packing Nut	Brass
6	Stem	Brass
7	Handle Nut	Plated Steel
8	Packing	PTEE
9	Handle	Al Alloy
10	Cap	Brass

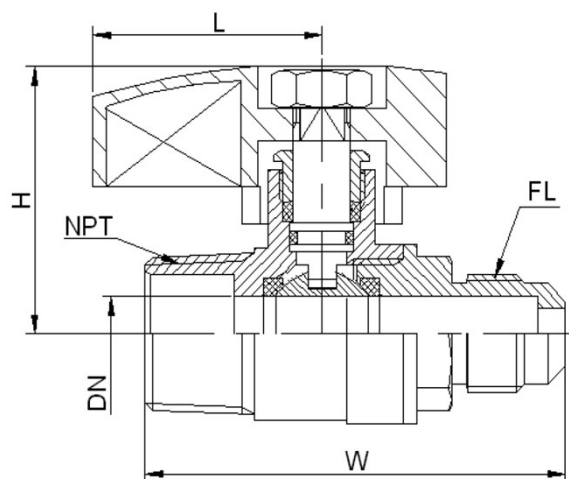

Dimensions

Part #	Size (Inches)	DN	L	H	W	Gas Flow (m3/hr)
605400005	1/2 MIP THREAD x MALE FLARE - BALL VALVE	0.394	1.28	1.437	2.480	2.45

Approvals

CSA	ANSI Z21.15/CSA 9.1 for 1/2 psig	ASME B16.44 /CR91-002 for 5 psig
UL	UL 842 (Guide YRBX, MHKZ)	UL 1477 (Guide YQNZ)
	UL 125 (Guide YSDT, YRPV)	